



542 3Rd Street, Lake Elsinore, CA 92530

TEL: 951-245-8669, FAX: 951-245-5481



ASTON MARTIN V8 VANTAGE 2005-2017

U.S. PATENTS

#6,808,223; #6,845,547; #7,140,075; #7,059,655

PATENTS AGGRESSIVELY ENFORCED!

**PLEASE CAREFULLY READ ALL INSTRUCTIONS BEFORE
ATTEMPTING TO INSTALL THIS PRODUCT.**

**FOR QUESTIONS PLEASE
CONTACT US AT (951) 245-8669**

**OTHER TOOLS MAY BE NEEDED DEPENDING ON YOUR VEHICLE.
"Installers with experience recommended"**

**(Note: The pictures on the manual are for reference only
they may not match your vehicle.)**

1) Disconnect the battery.

2) Remove fender:

Remove the hood cover and the 4 bolts holding the top of the fender in place.

Remove all Phillip's screws or fasteners from the wheel well, the bottom of the fender and the bottom of the side skirt. This will allow you to get access to the bolts behind the fender.

Once you have removed the fasteners around the wheel well you should be able to pull it back and gain access to 3 bolts holding the fender in place 1 on the skirt and two on the apron.



Open the door and remove one bolt at the top of the door holding the fender in place



Remove the weather stripping from around the bottom of the door. This will give you access to the top side skirt bolts that hold the fender and side skirt in place.



Remove the bolts from the front of the fender. Pull on the head light sprayer located at the bottom of the headlight, this will give you access to bolt (#1). Remove bolt (#1) first, then pull the fender well cover back to gain access to the other 2 bolts holding the fender in place. Now you should be able to remove the fender.

3) Close the door and use painter's tape to secure the door in preparation for factory hinge removal.



Make sure to mark the factory door position on the vertical and horizontal planes.



Also make sure to measure the distance from the body to the edge of the door. This will ensure that the door and fender meet like factory once you install the new VDI kit.

Use spacers under the door and in the door/quarter panel gap so the door does not move

Remove the factory hinges.

Hint (You can make your spacer out of paint sticks and about 8-10 turns of blue painters' tape)*



4) Install new Vertical Doors Inc. system:

Install the new VDI kit. You will have to cut the factory wire boot in half (Do not cut the factory wires) Use the enclosed wire loom to protect the factory wires as shown.

Use the provided spacer with the M8 X1.25 X 80MM bolt and washer to secure the back of the kit to the body of the car as shown

You will need to drill a hole in the car chassis and use a tap

Hint Tighten the bolts on the door first and then install the bolts on the body.*

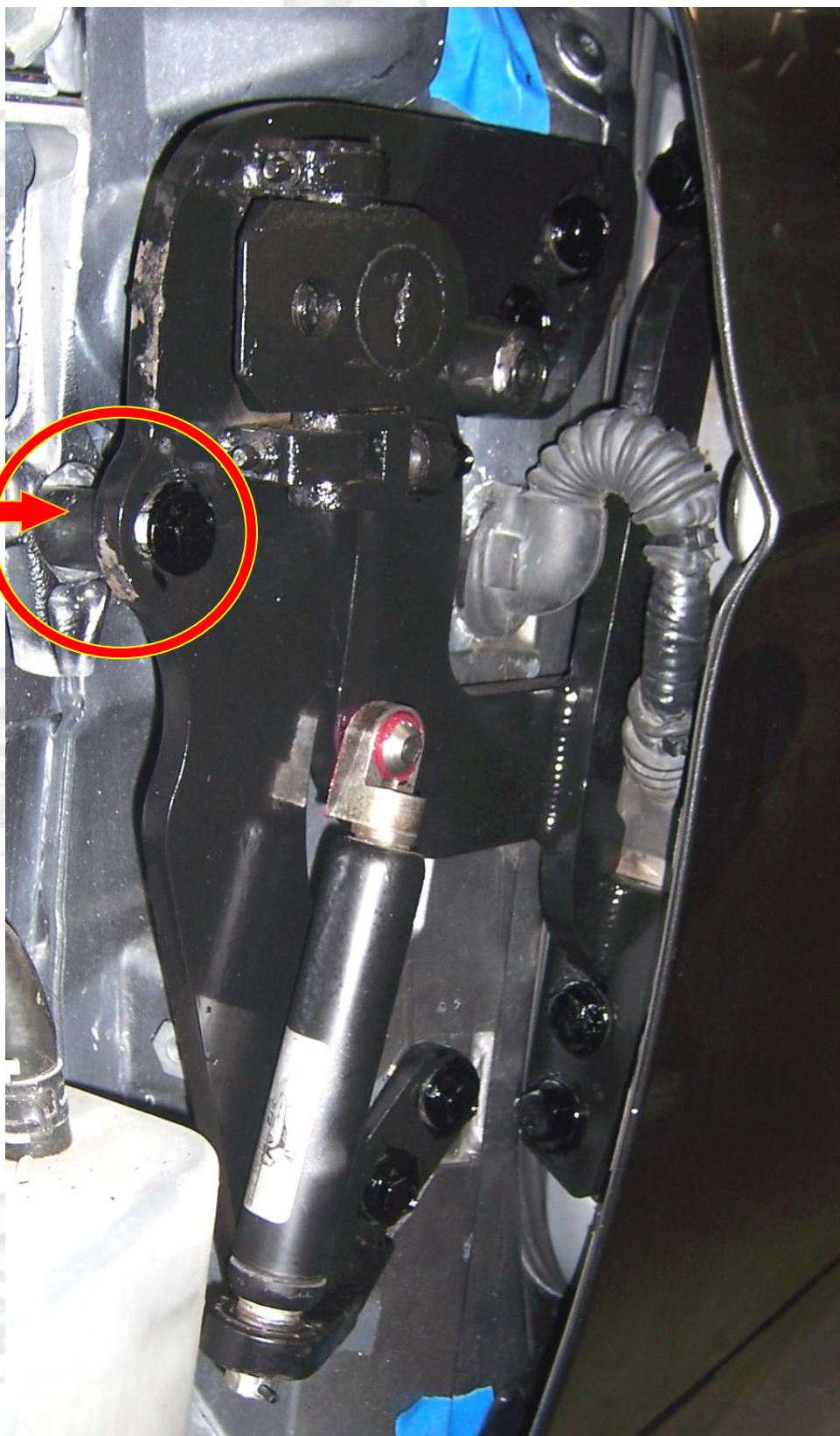

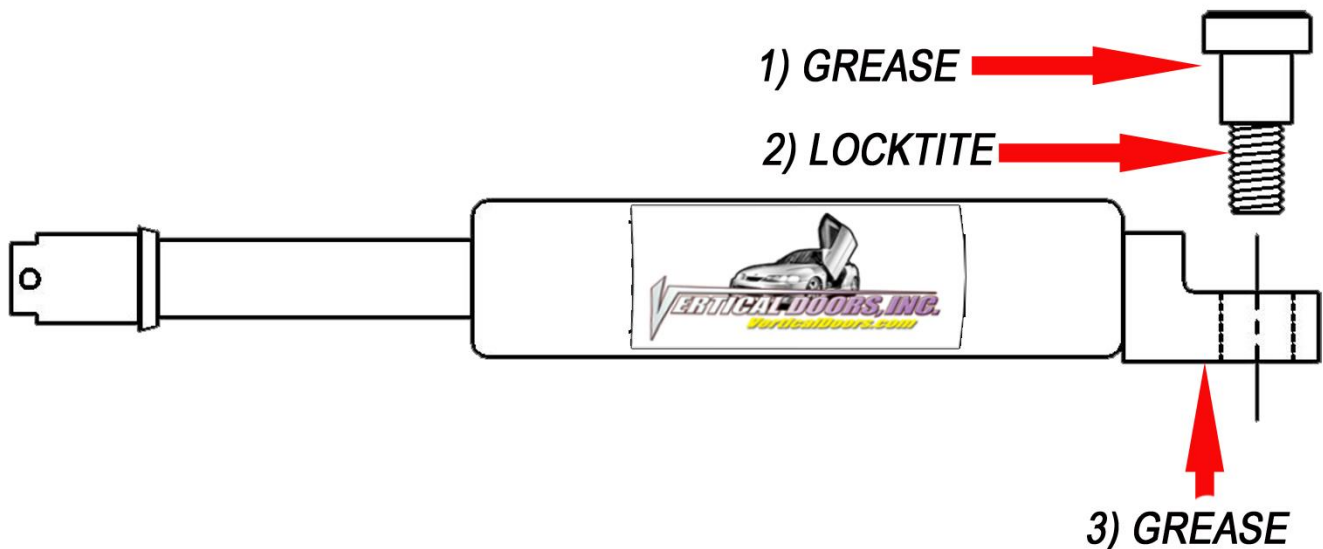

****IMPORTANT STEP: DO NOT SKIP THIS STEP. THIS STEP IS CRUCIAL IN YOUR INSTALLATION PROCESS, IF THIS STEP IS NOT COMPLETED WHEN INSTALLING THE VERTICAL DOOR KIT; ALL WARRANTIES ARE VOIDED, AND MAY CAUSE FUTURE PROBLEMS WITH YOUR VERTICAL DOOR SYSTEM.***

1ST, make sure you put grease on the body of shoulder bolt where the arrow is pointing.

2ND, make sure you put red Locktite, where the arrow is pointing, on thread of shoulder bolt.

3RD, make sure you put grease on the bottom side of the shock end.

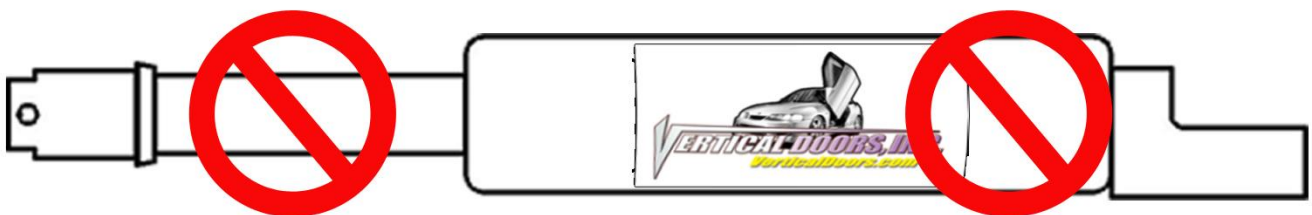

WARNING! THE USE OF ANY TYPE PLYERS, PAINT OR FOREIGN MATERIALS ON THE SHOCK'S BODY OR SHAFT WILL VOID THE WARRANTY.

5) Once hinge is locked in place, break nut #1 then turn Allen set screw #2 on fig until it hits the block then open the door and continue to adjust until the door matches with the striker, open and close door making sure it closes like factory.

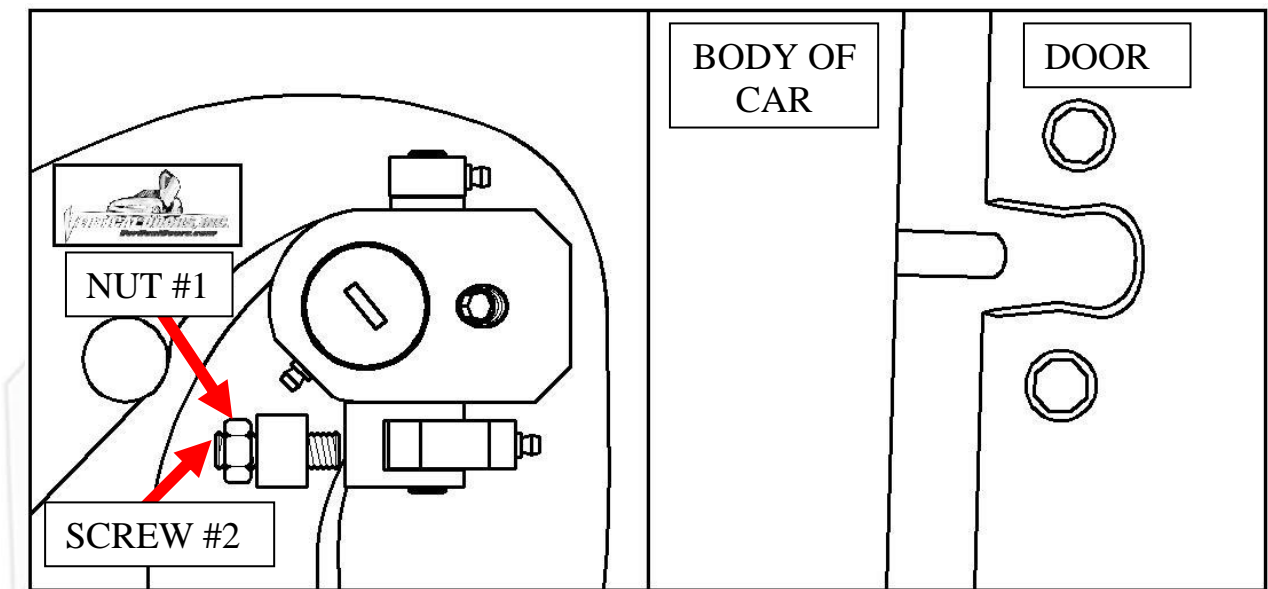

Hint(leave #1 nut loose until shock is installed Allen set screw will have to be re-adjusted after shock is installed).*

6) Install the shock.

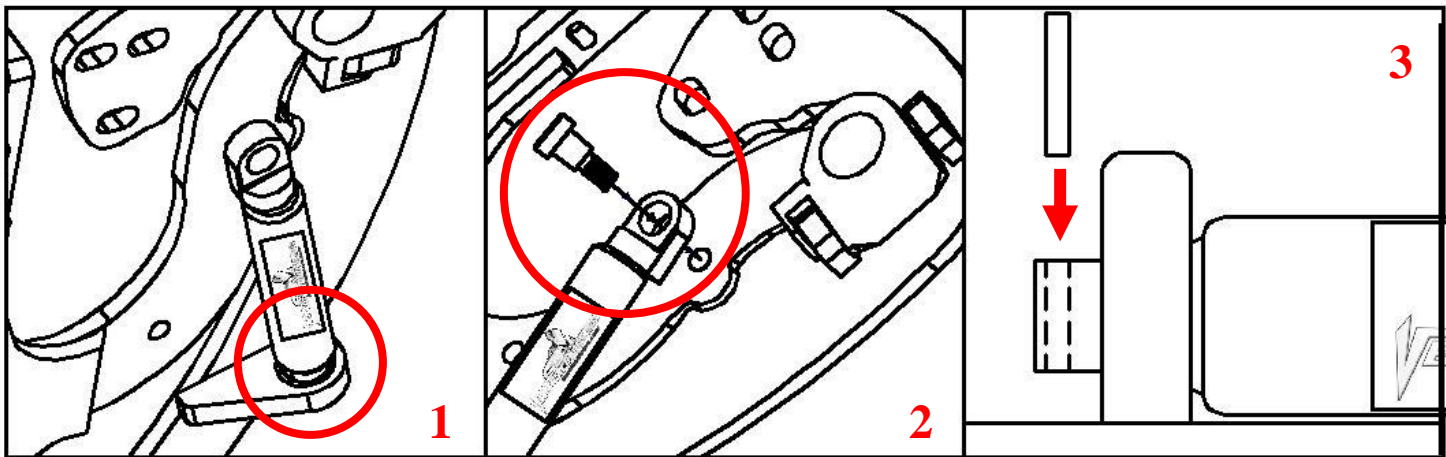

Hint (You will need a helper to raise the door). (Slip the spherical rod mount into the spherical ball bearing (1). Using a 1/4 Allen wrench, tighten the screw into the swing arm (2). After the shock is installed secure it by installing the pin in the bottom shock end (3).*



7) After shock is installed re-install door panel and lift the door. Adjust door opening screw #3 clockwise until distance between nub

and swing arm is enough so that the swing arm moves up and down freely.

Hint (Fine tune the Allen Adjustment screw (#2) to realigned striker with door. After the door is align test door by opening and closing, lifting and lowering door several times.*

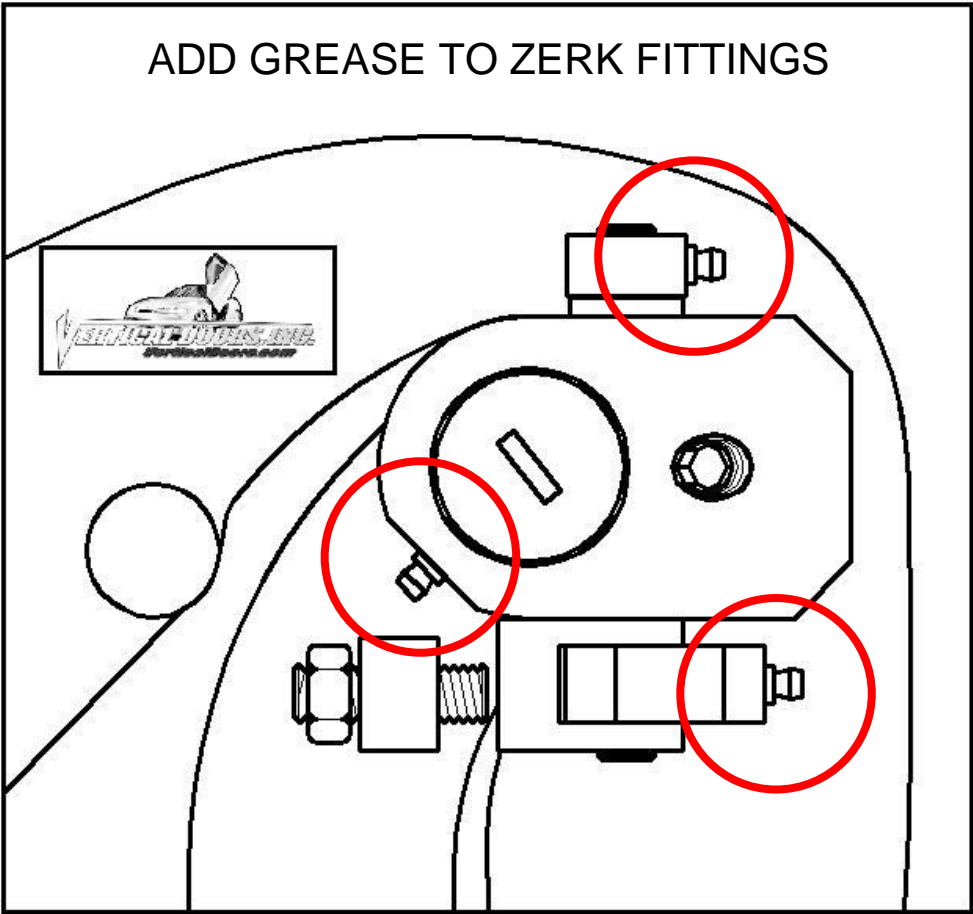
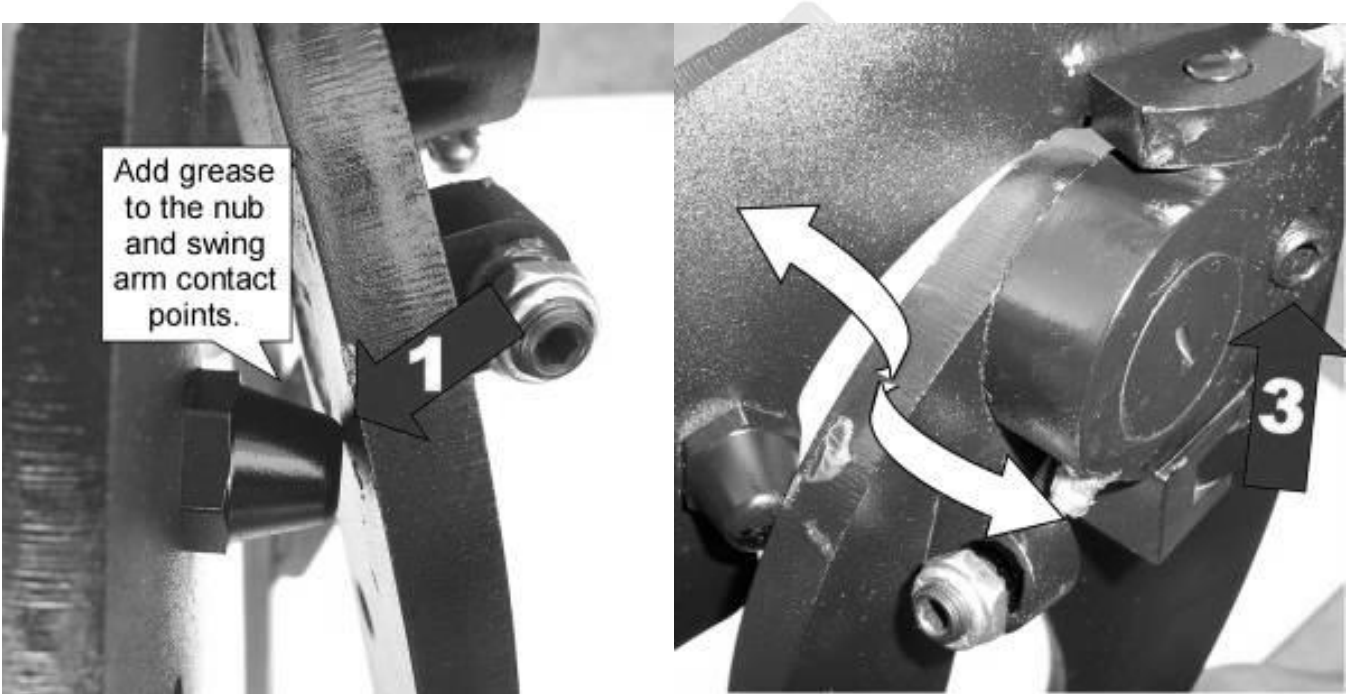

Note: Do not install fender until the adjustment of the door is accurate, and the set screw is tightly secure. Also make sure everything is tight, and confirm the use of Locktite threadlocker.

8) Cut the inner lip of your fender to make room for the new Vertical Doors hinge. Note: After you have cut the fender use a sander or grinder and make sure the surface is completely flat.



The fender side vent will have to be modified in order for the VDI kit to work. You will have to machine or grind down as shown



You will have to machine the vent cover as shown.



Put the fender back together and test fit the fender to the car. Make sure there is no contact between the VDI Hinge and the fender side vent. After make sure the kit works properly. Replace the fenders making sure to match up the factory marks in step 3.

The front side window will have to be modified in order for the door to close properly.



Shave a little bit at the time until the door closes smoothly.

VERTICAL DOORS, INC.
VerticalDoors.com

9) For the other side just follow steps 2-8.



Thank you for your purchase of the
VERTICAL DOORS INC. SYSTEM

Simply Uplifting

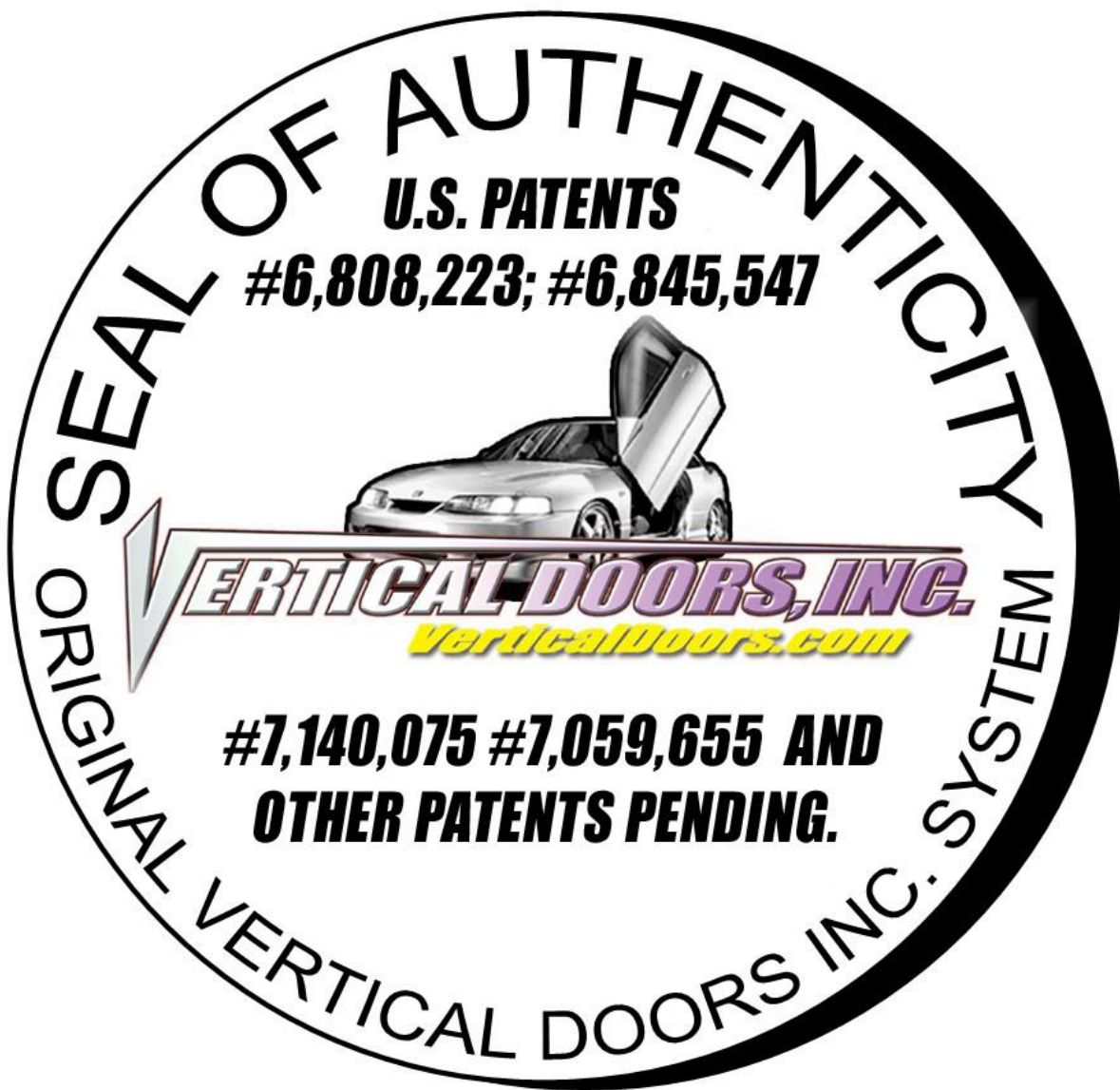

NOTE:

Vertical Doors Inc. assumes no responsibility for any damages caused by improper installation